

Gyproc® DriLyner®

Drywall Adhesive

Gyproc® DriLyner® Drywall Adhesive Plaster is a specially formulated gypsum-based plaster. It is easy to work with, saving time and cost. With its special adhesive property, Gyproc® DriLyner® Drywall Adhesive Plaster is used as part of the **"Gyproc® DriLyner® System"** and it needs to bond gypsum boards with any types of background. The **"Gyproc® DriLyner® System"** is the fastest method of refurbishing an existing wall. It produces a perfectly flat surface easily and also provides external heat insulation property, which helps saving in electricity consumption of rooms equipped with air conditioning systems.



Drywall Adhesive

Special Properties



Quick & Easy to Install:

Apply adhesive dabs to required areas and position boards against dabs. The quick set property of adhesive means that the **"Gyproc® DriLyner® System"** enables rapid installation up to 40 sq.m /day, which is 4 times faster than Sand & Cement System. The job site is kept dry and clean. It is ideal for refurbishment at any sites under time limitation condition.



Excellent Adhesion:

Gyproc® DriLyner® Drywall Adhesive Plaster is a specially formulated gypsum-based adhesive plaster. With its high quality raw materials and standard production technology, Gyproc® DriLyner® Drywall Adhesive Plaster gives excellent bonding between gypsum boards and any kinds of background, especially bricks, blocks, concrete or sand & cement walls.



Gyproc® DriLyner® Drywall Adhesive Plaster

Bag Size	25 kg / bag
Total Thickness	20 mm
Working Time	60 minutes after mixing with water
Water Requirement	12 litres per bag
Approximated Coverage	5-6 sq.m / 25 kg bag
Storage Method	Keep in a dry place without high humidity condition and do not expose to direct sunlight
Adhesive Value	$1.45 \times 10^6 \text{ N/m}^2$
Product Standard	EN 14496

Specification Guide

To level Masonry Walls, use Gyproc® DriLyner® System comprising of Gyproc® 12 mm board lined onto existing wall using Gyproc® DriLyner® Drywall Adhesive Plaster which has adhesive strength according to ASTM C952-91 = $1.45 \times 10^6 \text{ N/m}^2$, placed in three vertical rows of at least six dabs of size 250 mm x 50 mm for each piece of standard board size and full dabs for wall perimeters and around openings providing maximum air gap up to 20 mm board joints secured with Gyproc® Tape and finished with Gyproc® JOINTING for a seamless finish.

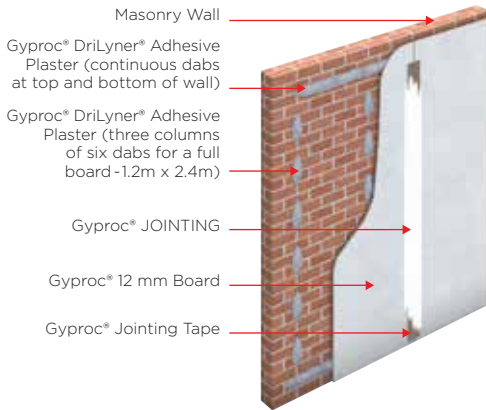

Comparing of a concrete wall finished with conventional sand & cement plastering and finished with an application of **Gyproc® DriLyner® Drywall Adhesive Plaster**

Comparative Characteristics	Conventional Sand & Cement Method	Gyproc® DriLyner® Drywall Adhesive Plaster
Wall Surface after finished	Rough because of sand aggregates.	Smooth and perfectly flat.
Working Preparation	Non-standard mixing ratio of cement aggregates and water. Experience of worker influences. Dirty working area. Needs larger working space.	Installer applies standard mixing ratio without aggregates. Easy to work with and required working space is minimal.
Repairing Evidences	Difficult to repair and always seen repairing marks left on surface of wall due to scratched or chiseled before repairing.	Easy to repair and no repairing marks left.
Surface Smoothness	Inferior due to its roughness and dark color.	Smooth, flat and light color
Thermal Transfer from outside	High thermal transfer due to its cement content.	Very low due to thermal insulation property.

Preparation & Installation



1 Surface of background must be dry, clean and free from dust or grease. Remove imperfections such as dry cement built from surface. Determine the highest spots on the wall and plumb position to the ceiling and floor.



2 Transfer this dimension to the floor and soffit, Mark background walls with vertical lines at every 1.20 m interval.



3 Mix Gyproc® DriLyner® Drywall Adhesive Plaster with clean water according to the recommended ratio. A dab of adhesive should be 50 mm wide and about 250 mm long.



4 Trowel apply a continuous fillet of Gyproc® DriLyner® Drywall Adhesive Plaster at skirting level.

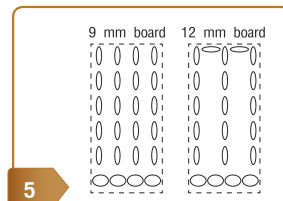

5 Position dabs of adhesive in three vertical rows. Apply six dabs a row to receive the board. Ensure that the dabs adjacent to a board joint are approximately 50 mm in from the edge to avoid bridging the joint. Apply a continuous dab of adhesive at ceiling and skirting levels.



6 Position the first board, grey face against the dabs, with the bottom edge resting on a small piece of gypsum board. Tab the board back firmly using a straight-edge until it aligns with the ceiling and floor lines. Leave it set. Finish board joints, hide screw heads and allow to set/dry. Remove imperfections ready for further decorations.

SAINT-GOBAIN

Written enquiries should be addressed to:
Thai Gypsum Products Pcl.
 Gypsum Metropolitan Tower
 539/2 Si Ayutthaya Road,
 Ratchathewi, Bangkok 10400
 Thailand
 Tel: +66 2 640-8600

Technical Support
 Tel: +66 2 640-8787

Customer Service Centre
 Tel: +66 2 640-8700
 Fax: +66 2 640-8770
 E-mail : export.tgp@saint-gobain.com
www.gyproc.co.th

VERSION : 07/2017



www.gyproc.co.th



Gyproc Thailand